

Sainsbury Building (43)  
Ground Floor

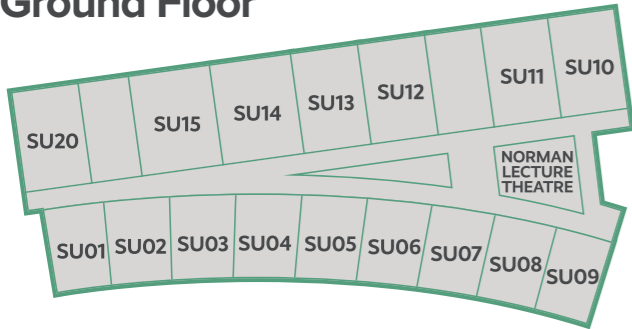

Sainsbury Building (43)  
Lower Ground Floor

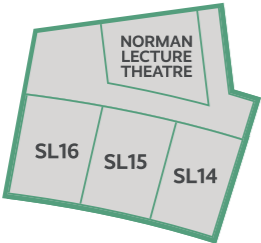

Saxony, Pod/DigiHub 2 (29)

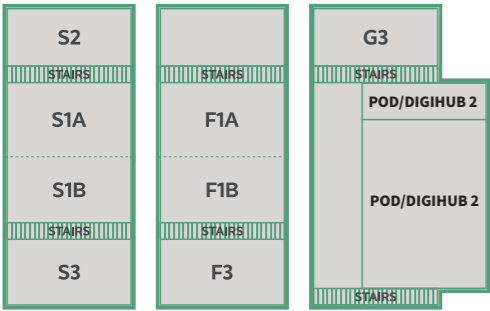

Engineering (15)

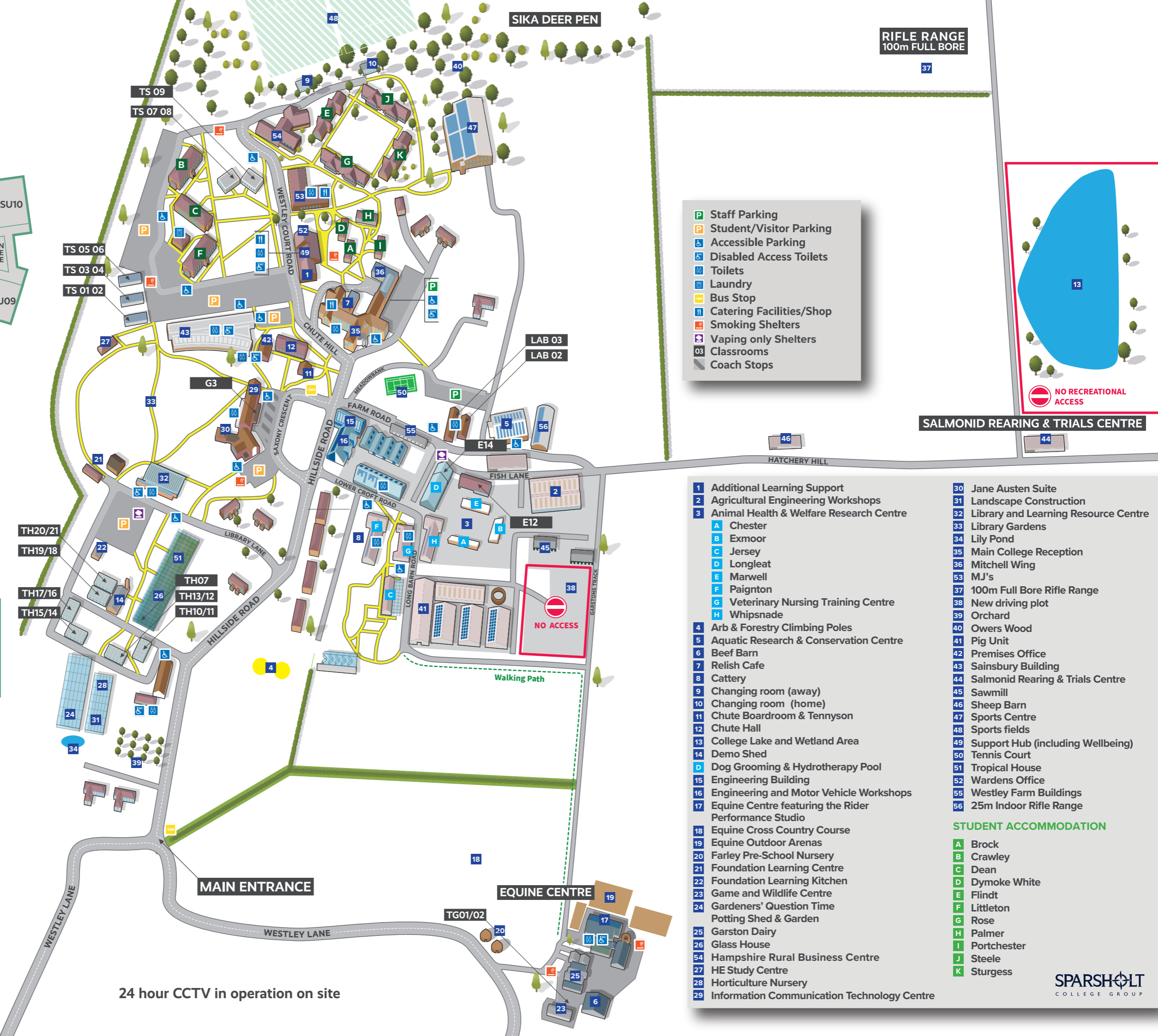
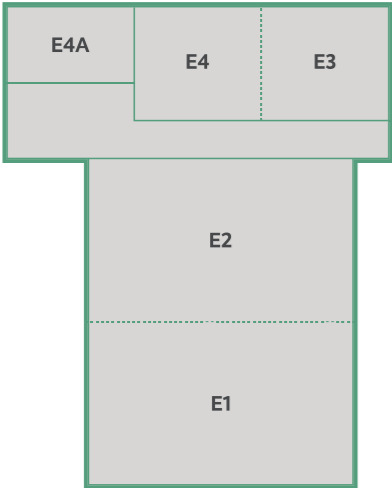

- Staff Parking
- Student/Visitor Parking
- Accessible Parking
- Disabled Access Toilets
- Toilets
- Laundry
- Bus Stop
- Catering Facilities/Shop
- Smoking Shelters
- Vaping only Shelters
- Classrooms
- Coach Stops

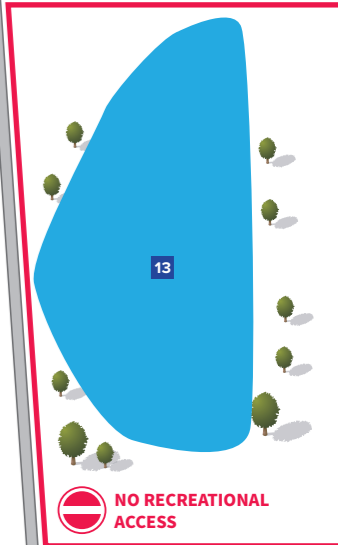

- 1 Additional Learning Support
  - 2 Agricultural Engineering Workshops
  - 3 Animal Health & Welfare Research Centre
  - A Chester
  - B Exmoor
  - C Jersey
  - D Longleat
  - E Marwell
  - F Paignton
  - G Veterinary Nursing Training Centre
  - H Whipsnade
  - 4 Arb & Forestry Climbing Poles
  - 5 Aquatic Research & Conservation Centre
  - 6 Beef Barn
  - 7 Relish Cafe
  - 8 Cattery
  - 9 Changing room (away)
  - 10 Changing room (home)
  - 11 Chute Boardroom & Tennyson
  - 12 Chute Hall
  - 13 College Lake and Wetland Area
  - 14 Demo Shed
  - D Dog Grooming & Hydrotherapy Pool
  - 15 Engineering Building
  - 16 Engineering and Motor Vehicle Workshops
  - 17 Equine Centre featuring the Rider Performance Studio
  - 18 Equine Cross Country Course
  - 19 Equine Outdoor Arenas
  - 20 Farley Pre-School Nursery
  - 21 Foundation Learning Centre
  - 22 Foundation Learning Kitchen
  - 23 Game and Wildlife Centre
  - 24 Gardeners' Question Time Potting Shed & Garden
  - 25 Garston Dairy
  - 26 Glass House
  - 54 Hampshire Rural Business Centre
  - 27 HE Study Centre
  - 28 Horticulture Nursery
  - 29 Information Communication Technology Centre
  - 30 Jane Austen Suite
  - 31 Landscape Construction
  - 32 Library and Learning Resource Centre
  - 33 Library Gardens
  - 34 Lily Pond
  - 35 Main College Reception
  - 36 Mitchell Wing
  - 53 MJ's
  - 37 100m Full Bore Rifle Range
  - 38 New driving plot
  - 39 Orchard
  - 40 Owers Wood
  - 41 Pig Unit
  - 42 Premises Office
  - 43 Sainsbury Building
  - 44 Salmonid Rearing & Trials Centre
  - 45 Sawmill
  - 46 Sheep Barn
  - 47 Sports Centre
  - 48 Sports fields
  - 49 Support Hub (including Wellbeing)
  - 50 Tennis Court
  - 51 Tropical House
  - 52 Wardens Office
  - 55 Westley Farm Buildings
  - 56 25m Indoor Rifle Range
- STUDENT ACCOMMODATION**
- A Brock
  - B Crawley
  - C Dean
  - D Dymoke White
  - E Flindt
  - F Littleton
  - G Rose
  - H Palmer
  - I Portchester
  - J Steele
  - K Sturgess